

Your Professional Valve Solution



[www.tipvalve.com](http://www.tipvalve.com)

## Bellow globe valve



Tipvalve is specialized in industrial valves' production, research and development, sales and service.

Offer the valve solution in rigorous working condition for customers, especially in atrocious working condition, sea water and other corrosive media.

Tipvalve is widespread recognized relying on rich experiences and technical support.

# TIPVALVE INDUSTRIAL GROUP LTD.



## Bellow Globe Valve

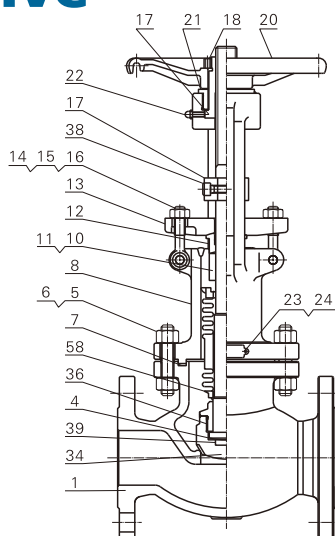

### Main parts material sheet

Item	Part name	WCB	CF8	CF3	CF3M	CE3MN
1	Body	A216 WCB	A351 CF8	A351 CF3	A351 CF3M	CE3MN
4	Stem	A182 F6a	A182 304	A182 F304L	A351 F316L	A182 F53
5	Bolt	A193 B7	A193 B8	A193 B8	A193 B8M	A193 B8M
6	Nut	A194 2H	A194 8	A194 8	A194 8M	A194 8M
7	Gasket	304+flexible graphite	304+flexible graphite	304+flexible graphite	316+flexible graphite	316+flexible graphite
8	Bonnet	A216 WCB	A351 Cf8	A351 Cf3	A351 CF3M	CE3MN
10	Packing	304+flexible graphite	304+flexible graphite	304+flexible graphite	316+flexible graphite	316+flexible graphite
11	Distance ring	A182 F6a	A182 F304	A182 F304L	A182 F316L	A182 F53
12	Packing gland	A182 F6a	A182 F304	A182 F304L	A182 F316L	A182 F53
13	Packing plat <sub>e</sub>	A216 WCB	A351 CF8	A351 CF8	A351 CF8	A351 CF8
14	Eye bolt	A193 B7	A193 B8	A193 B8	A193 B8M	A193 B8M
15	Nut	A194 2H	A194 8	A194 8	A194 8M	A194 8M
16	Pin	1035	304	304	304	304
17	Stem bolt	A439 type D2	A439 type D2	A439 type D2	A439 type D2	A439 type D2
18	Locking nut	1035	1035	1035	1035	1035
20	Hand wheel	Dulere LI0m	Dulerle L10m	Ducerle L10m	Ducerle L10m	Ducerle L10m
21	Bearing gland	1035	1035	1035	1035	1035
22	Oil cup	Finished product	Finished product	Finished product	Finished product	Finished product
23	Nameplate	304	304	304	304	304
24	Rivet	AL	AL	AL	AL	AL
34	Disc	A105	F304	F304L	F316L	F51
36	Dis <sup>c</sup> cover	1035	304	304L	316L	F53
37	Guide pad	1045	1045	1045	1045	1045
38	Hex. Bolt	A193 B7	A193 B7	A193 B7	A193 B7	A193 B7
39	Washer	420	304	304L	316L	F53
58	Bellow	F321	F321	F304L	F316L	F53

Note: the distance ring should be installed if user require



## Bellow Globe Valve

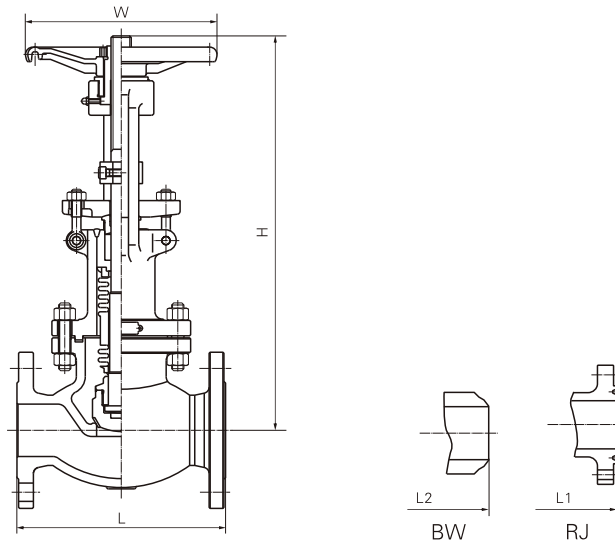

### 150Lb

Spec (NAP)	in	2	2 1/2	3	4	5	6	8	10	12	14	16
Face to face(mm)	L	203	216	241	292	356	406	495	622	698	787	914
	L1	216	229	254	305	369	419	508	635	711	800	927
	L2	203	216	241	292	356	406	495	622	698	787	914
Center height(mm)	H	455	520	570	710	790	860	1250	1460	1540	1800	2100
Hand wheel diameter (mm)	W	220	250	280	320	320	400	450	560	560	-	-

### 300Lb

Spec (NAP)	in	2	2 1/2	3	4	5	6	8	10	12	14	16
Face to face(mm)	L	267	292	318	356	400	445	559	622	711	838	863
	L1	283	308	334	372	416	461	575	638	727		
	L2	267	292	318	356	400	445	559	622	711		
Center height(mm)	H	500	550	620	790	860	950	1400	1500	1700		
Hand wheel diameter (mm)	W	220	350	280	320	400	450	500	560	600		

### 600Lb

Spec (NAP)	in	2	2 1/2	3	4	5	6	8	10	12	14	16
Face to face(mm)	L	292	330	356	432	508	559	660	787	838		
	L1	295	333	359	435	511	562	663	790	841		
	L2	292	330	356	432	508	559	660	787	838		
Center height(mm)	H	550	610	680	820	900	1050	1540	1620	1800		
Hand wheel diameter (mm)	W	285	280	320	400	-	560	600	650	760		